

May 2018

HSE Update

Mark Carroll

**HM Inspector of Health and Safety
HSE Construction Division**

Construction Division's work is never done...



Strategy and plans

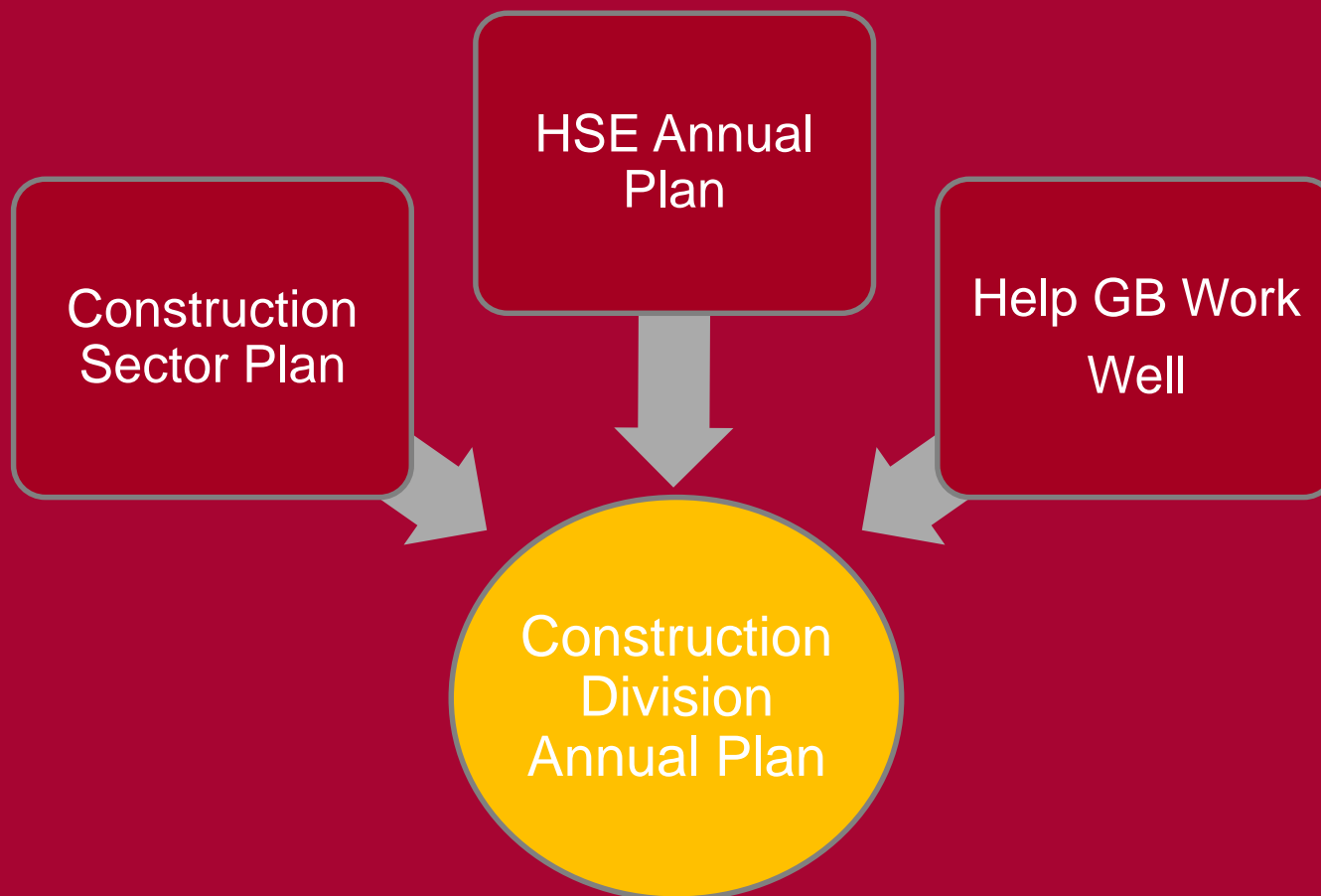

Helping GB Work Well



Acting together

Promoting broader ownership of health and safety in Great Britain



Tackling ill health

Highlighting and tackling the costs of work-related ill health



Managing risk well

Simplifying risk management and helping business to grow



Supporting small employers

Giving SMEs simple advice so that they know what they have to do



Keeping pace with change

Anticipating and tackling new health and safety challenges



Sharing our success

Promoting the benefits of Great Britain's world-class health and safety system

HSE's Annual Plan 2018/19 - Priorities

- **Lead and engage with others to improve work place health and safety**
- **Provide an effective regulatory framework**
- **Secure effective management and control of risk**
- **Reduce likelihood of low frequency, high impact catastrophic events**
- **Sustaining regulatory excellence**
- **Growing our commercial and externally funded activities**
- **Investing in HSE's people and capability**
- **Driving operational efficiency and effectiveness**

Construction Division's Plan 2018/19

- **Undertake a targeted, risk based programme of around 9000 proactive inspections throughout the year.**
- **One major inspection campaign targeting refurbishment work in June/July 2018.**
- **One major inspection campaign targeting health topics and reviewing controls in October 2018.**
- **Two London inspection campaigns targeting refurbishment work, with assistance from HSE Inspectors from across GB.**
- **Complete 240 asbestos licence assessments.**

Construction Division's Plan 2018/19

- **Undertake around 1000 licensed asbestos inspections.**
- **20 further inspections of architect and other practices, offering principal designer services, to assess compliance with CDM2015, and in particular for timber frame projects.**
- **Effective tracking back to clients, principal designers and designers for relevant issues identified during site-based/construction phase inspections.**

Construction Division's Plan 2018/19

- Undertaking assurance/inspection audit work for Dubai Expo 2020.



Construction Division's Plan 2018/19

- **Assisting Police Scotland and other regulators (WRDP for Scotland/Grenfell Tower investigation work).**
- **Updating of Construction Health and Safety Guidance documents, (HSGs 33/144/168).**
- **Report from MSD in construction inspection programme in 2017/18, leading this year to work with stakeholders and industry, to review causation in construction**
- **Research into potential issues arising from increase in off site construction methods**

Investigations

- **90% of fatal investigations to be completed within 12 months of HSE primacy.**
- **90% of non-fatal investigations to be completed within 12 months of the incident.**
- **75% of concerns to be followed up within 21 days, or investigated within 4 months**

Construction Visiting Officers

- Targeted programme of 60 visits and revisits using Construction Health Risk Toolkit (CHeRT) to small and medium sized companies.
- WWT Safety and Health Awareness Days (SHADs) continue across GB.
- SHADs arranged in Scotland so far for 2018/19:
- Early September 2018, venue tbc, stress, dust suppression techniques, people/plant interface, MSDs/HAVS.
- Lochgilphead Campus 17th October 2018 - work at height, construction dust, asbestos, stress, manual handling

Recent issues noted during visits

- **Unsafe excavations**
- **Unsafe people/plant interface**
- **Good order**
- **Access issues/scaffolds**
- **Unsafe work at height**
- **Lack of suitable welfare facilities**
- **COSHH – powered timber/tile/stone cutting**

Excavations – CDM 2015

- 22.—(1) All practicable steps must be taken to prevent danger to any person, including, where necessary, the provision of supports or battering, to ensure that—
 - (a) no excavation or part of an excavation collapses;
 - (b) no material forming the walls or roof of, or adjacent to, any excavation is dislodged or falls; and
 - (c) no person is buried or trapped in an excavation by material which is dislodged or falls.

Safe shoring?



Part 2



Good order – CDM 2015

- 18.—(1) Each part of a construction site must, so far as is reasonably practicable, be kept in good order and those parts in which construction work is being carried out must be kept in a reasonable state of cleanliness.

Good order



Good order



Roof truss delivery



Roof truss delivery

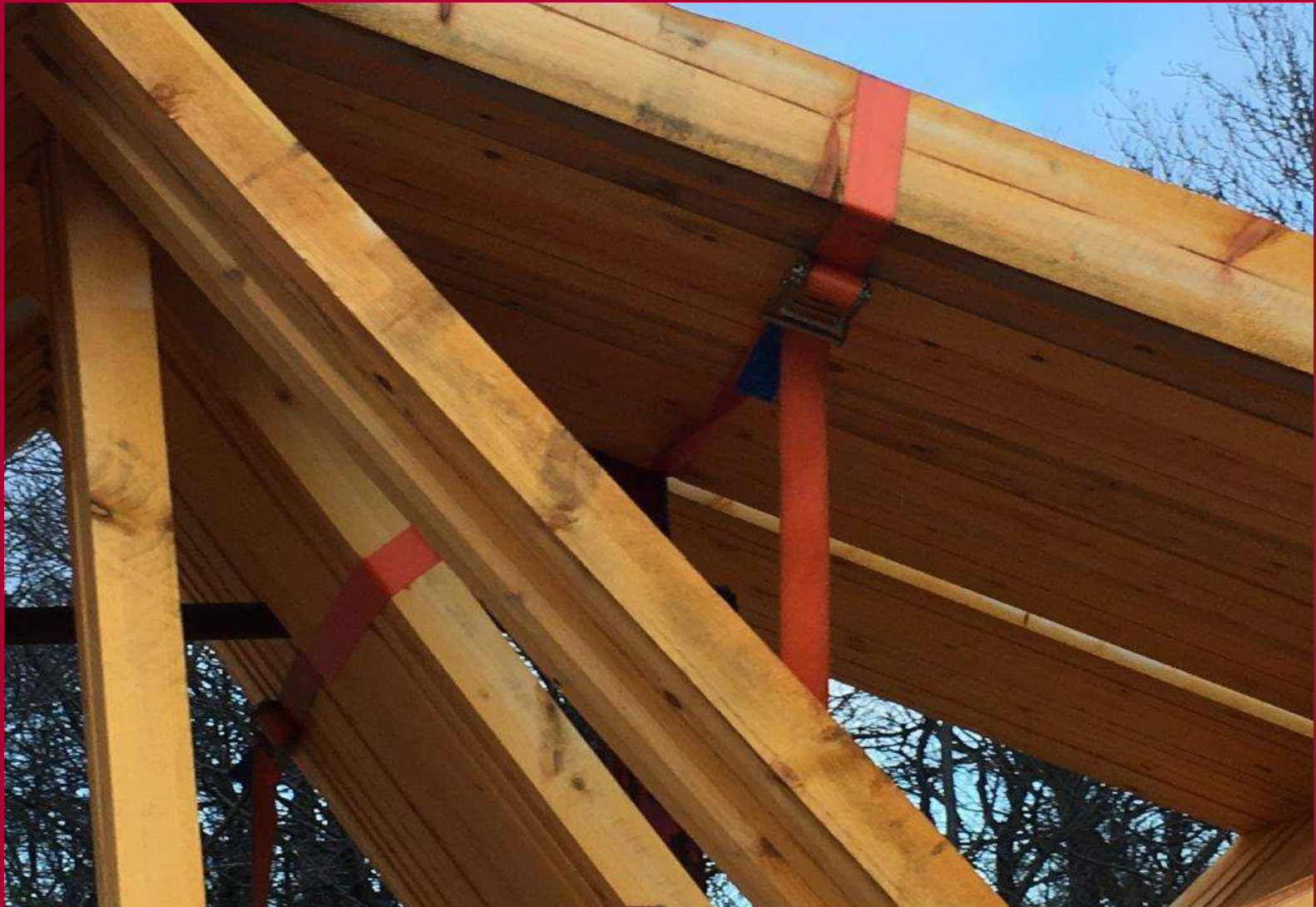

Roof truss delivery



Questions?

